

Galápagos

2024-2027 VOYAGES | EXPEDITIONS.COM

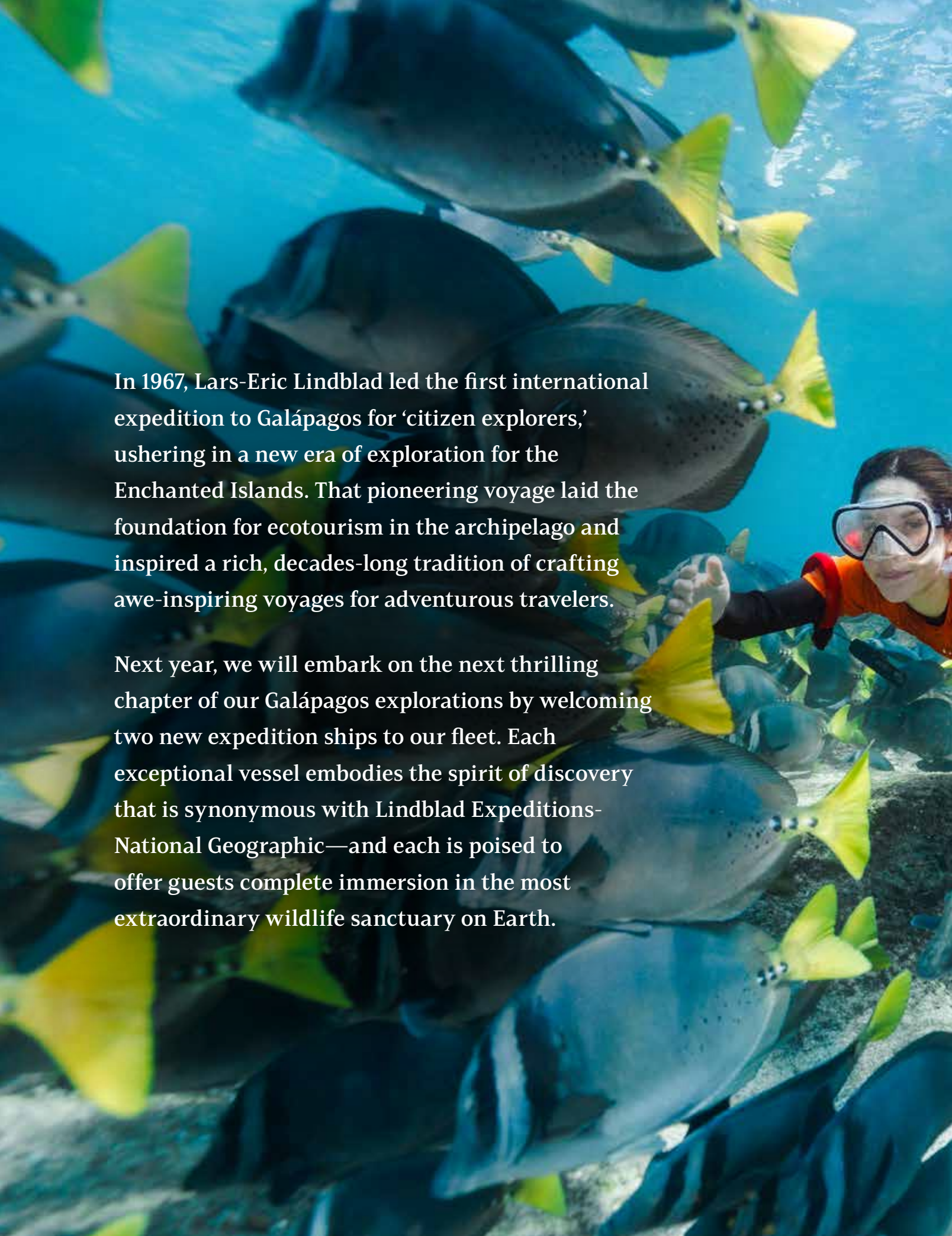

**Introducing *National Geographic Gemini*
and *National Geographic Delfina*, Sailing
the Islands in 2025**

A woman wearing a scuba mask and a red and black wetsuit is reaching out her hand towards a large school of fish underwater. The fish are dark grey with yellow tails and are swimming in clear blue water. The woman is smiling and looking towards the camera.

In 1967, Lars-Eric Lindblad led the first international expedition to Galápagos for ‘citizen explorers,’ ushering in a new era of exploration for the Enchanted Islands. That pioneering voyage laid the foundation for ecotourism in the archipelago and inspired a rich, decades-long tradition of crafting awe-inspiring voyages for adventurous travelers.

Next year, we will embark on the next thrilling chapter of our Galápagos explorations by welcoming two new expedition ships to our fleet. Each exceptional vessel embodies the spirit of discovery that is synonymous with Lindblad Expeditions-National Geographic—and each is poised to offer guests complete immersion in the most extraordinary wildlife sanctuary on Earth.

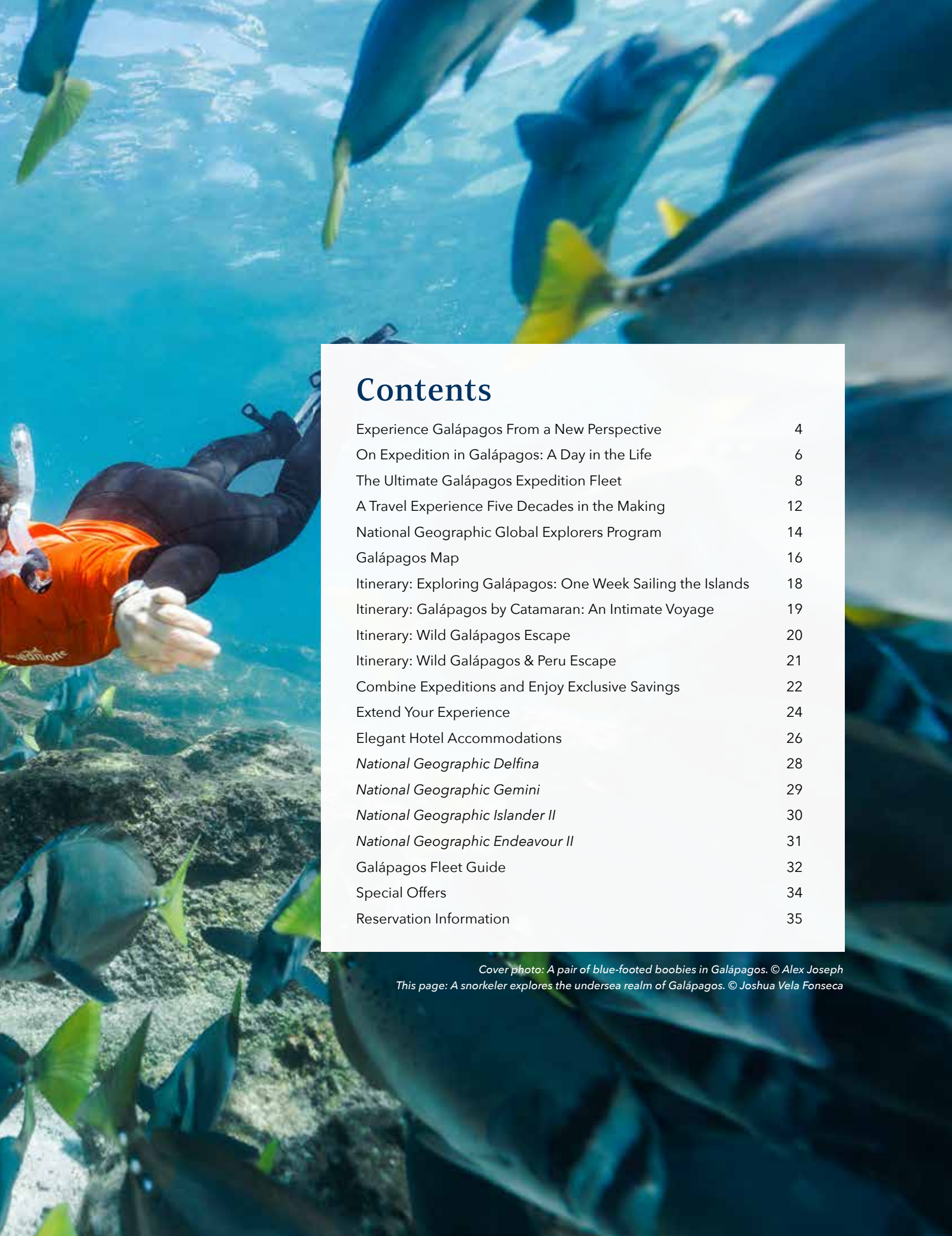

Contents

Experience Galápagos From a New Perspective	4
On Expedition in Galápagos: A Day in the Life	6
The Ultimate Galápagos Expedition Fleet	8
A Travel Experience Five Decades in the Making	12
National Geographic Global Explorers Program	14
Galápagos Map	16
Itinerary: Exploring Galápagos: One Week Sailing the Islands	18
Itinerary: Galápagos by Catamaran: An Intimate Voyage	19
Itinerary: Wild Galápagos Escape	20
Itinerary: Wild Galápagos & Peru Escape	21
Combine Expeditions and Enjoy Exclusive Savings	22
Extend Your Experience	24
Elegant Hotel Accommodations	26
<i>National Geographic Delfina</i>	28
<i>National Geographic Gemini</i>	29
<i>National Geographic Islander II</i>	30
<i>National Geographic Endeavour II</i>	31
Galápagos Fleet Guide	32
Special Offers	34
Reservation Information	35

Cover photo: A pair of blue-footed boobies in Galápagos. © Alex Joseph
This page: A snorkeler explores the undersea realm of Galápagos. © Joshua Vela Fonseca

Experience Galápagos From a New Perspective

Lindblad Expeditions and National Geographic are united in a shared mission to take curious travelers deep into wild places that paint a richer picture of our world. Together, we craft itineraries that inspire and transform, pushing the boundaries of discovery to offer unique experiences and foster a greater understanding of our planet's natural and cultural treasures.

A Veteran Team

Every member of our team—from our naturalists and photographers to our expedition leaders—is committed to ensuring you have an unforgettable experience. Many of our veteran guides are *Galapagueños*; in addition to sharing their extensive knowledge of island species and habitats, they also offer an authentic connection to the region's culture. Exploring in small groups, you will have the opportunity to hear different perspectives every day, and because there are no group assignments, you can gravitate toward naturalists who share your interests.



Actively Explore Every Day

Our Galápagos itineraries feature a range of immersive activities that bring you into the pages of *National Geographic*. Excursions are designed for every skill level so you can personalize your experience in this legendary archipelago. Snorkel or scuba dive* with acrobatic sea lions, go on a photo walk to capture up-close images of blue-footed boobies, take a ride in a glass-bottom boat, and much more. You can explore your way every day.



With Lindblad Expeditions-National Geographic

In-Depth Undersea Program

Our undersea program reveals the wonders hidden in Galápagos waters. Voyages feature an undersea specialist who documents the marine environment, gathering footage for daily recaps in the lounge so that all guests can glimpse the fascinating sea creatures and their oceanic habitats.



**Scuba diving is available for experienced divers on select departures and at an additional cost. Diving excursions are run by a local operator.*

ALL IN: Activities and excursions are always included in the voyage price unless otherwise noted.

Commitment to Community and Conservation

Sustainability is at the heart of the Lindblad Expeditions-National Geographic mission, and you can travel with peace of mind, knowing every voyage we sail here gives back to the Galápagos. Together with our guests, we have donated more than \$10 million to the conservation of Galápagos habitats and communities. Plus, a percentage of sales in the onboard Global Gallery goes to our Artisan Fund, supporting artisan communities worldwide. Many of the handcrafted items for sale in Galápagos are crafted locally by artisans we support.



Sustainable practices are also embedded in our operations so that every aspect of your experience reflects this unique part of the planet—from the food served on board, to special excursions to island farms and schools, and the perspectives shared by the local researchers and community leaders who join us along the way.

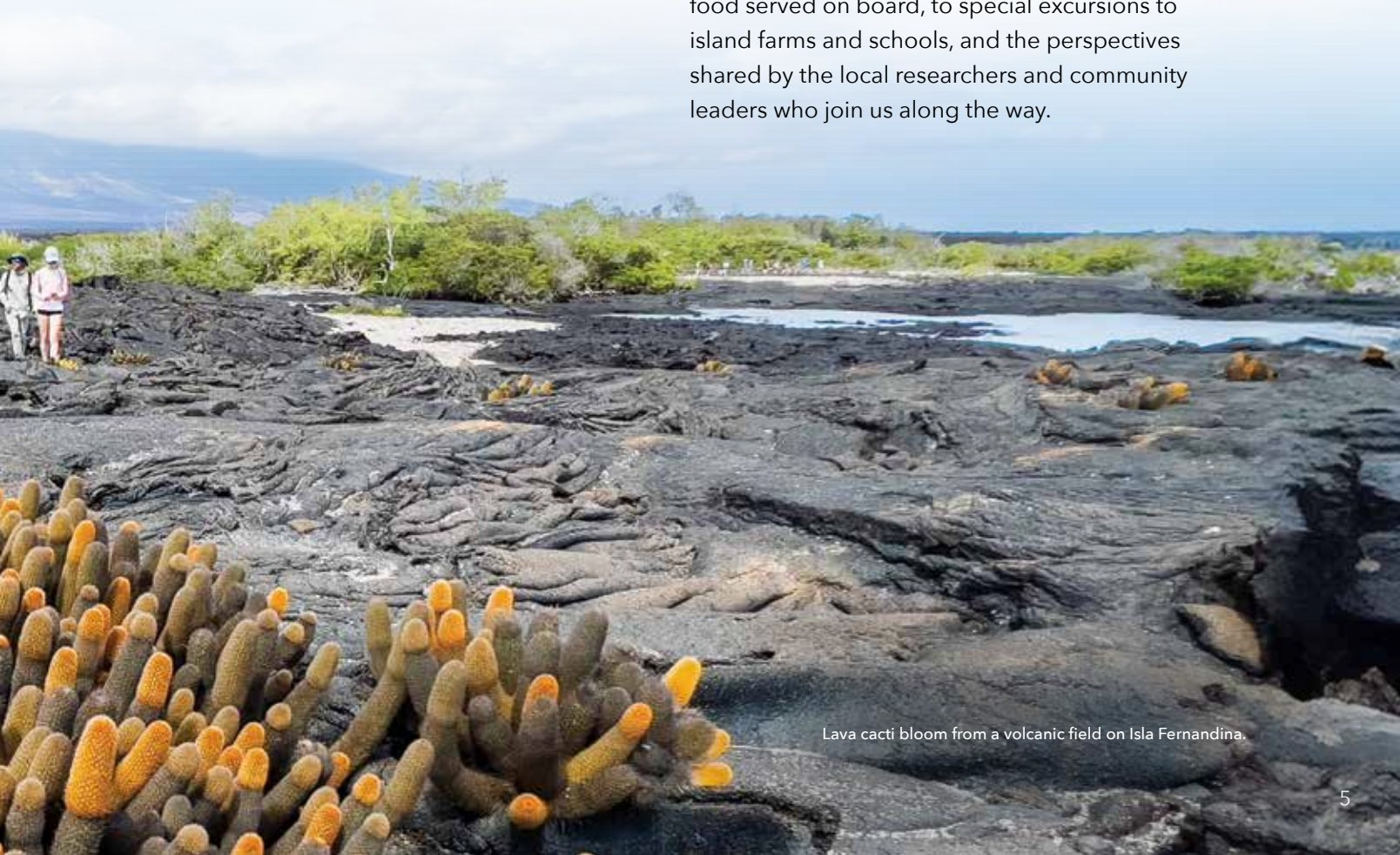

Lava cacti bloom from a volcanic field on Isla Fernandina.

On Expedition in Galápagos: A Day in the Life

Welcome to the greatest wildlife show on Earth. The animals of the Galápagos are unusual, unafraid, and overwhelmingly endemic, and observing these fascinating creatures in the company of our knowledgeable team is the hallmark of the Lindblad Expeditions-National Geographic experience.

Each day in the Galápagos is different, and there is always a variety of enticing adventures on offer, whether you wish to pack your day with active excursions or are more inclined to leisurely explorations.



Rise and Roam

Greet the day on the top deck, practicing sun salutations and stretching with our wellness specialist, or head to the bow to look for early-morning wildlife activity alongside our expert naturalists. A fresh breakfast awaits in the dining room: bespoke omelets, a rainbow of fruits and juices, Galápagos-grown coffee, and more—much of it sourced from local farms as part of our pioneering farm-to-table program.

Dive In

Gear up for a snorkeling adventure in the Galápagos Marine Reserve, home to an array of captivating creatures: somersaulting sea lions, schools of technicolor fish, swimming marine iguanas, and feeding penguins. Prefer to stay dry? Ride a Zodiac or glass-bottom boat alongside a pod of dolphins or into a shallow bay teeming with surfacing sea turtles.



Naturalist Talks and Photo Tips

Back on board, join a naturalist or National Geographic certified photo instructor in the lounge for an engaging talk or a photo tips session. Or take advantage of the ship's amenities: head to the fitness center, relax in a hammock on deck, or read up on Charles Darwin in the library.



A Local Lunch

Every meal on your voyage is fresh, sustainable, and locally sourced, but one lunch stands out: a special Ecuadorian feast, with dishes from the country's coasts, islands, and highlands. The golden roast suckling pig from Isla Floreana is a highlight, as is the ceviche and wild-caught fish in coconut milk.



Paddle, Hike, or Walk

Paddle a kayak or stand-up paddleboard along shore for a closer look at fascinating volcanic features and textures. Or head ashore with your camera in hand for a birding walk. Sightings depend on the island—but keep a lookout for blue-footed boobies or waved albatrosses performing their elaborate courtship dances, and flightless cormorants diving for fish.

Ready for Recap

Meet in the lounge over drinks and hors d'oeuvres, and settle in for the daily recap, featuring presentations and photo slideshows on the day's adventures and a preview of tomorrow's activities.



Seeing Stars

Bring your binoculars to the top deck for a naturalist-led stargazing session, where you have the rare opportunity to see the Big Dipper and Southern Cross at the same time—a phenomenon that only happens at the Equator.

The Ultimate Galápagos Expedition Fleet

In 2025, Lindblad Expeditions-National Geographic will welcome two new purpose-built ships to the Galápagos fleet, reinforcing our enduring legacy as the premier expedition cruise company in the islands.

Following multi-million-dollar revitalizations, National Geographic Delfina and National Geographic Gemini will sail the archipelago year-round along with guest-favorites National Geographic Endeavour II and National Geographic Islander II. Together, these four exceptional vessels offer a full spectrum of travel options for our guests, whether you wish to voyage solo or with family—or charter an entire ship for a private experience.

National Geographic Delfina

Upon her launch in February 2025, *National Geographic Delfina* will be our most intimate ship in Galápagos, accommodating 16 guests in eight spacious staterooms. This sleek and contemporary luxury catamaran with a double hull was specially designed for cruising the islands in style and stable comfort. Each spacious air-conditioned stateroom is furnished with polished wood décor and has either a private balcony or direct access to an expansive wooden deck.

The open-air observation deck affords 360-degree views and has a shaded area for relaxation, a whirlpool hot tub, and lounge chairs for taking in your surroundings. Dine al fresco on the wrap-around upper deck and enjoy spectacular island views as you watch for dolphins, whales, and other dazzling marine life. The dining room, bar, and cozy lounge and library are on the main deck, which also holds the Zodiac boarding area and marina, stocked with snorkel gear, stand-up paddleboards and kayaks for up-close exploration at water level.



Clockwise from top: National Geographic Delfina; main deck with intimate dining; observation deck with whirlpool hot tub.



LEARN MORE: Explore the sleek, intimate spaces of our new luxury catamaran.

National Geographic Gemini

National Geographic Gemini is a highly maneuverable, shallow-draft expedition ship purpose-built to explore remote waters with ease.

Accommodating 48 guests, she offers a variety of cabin configurations, with a mix of solos, doubles, triples, connecting cabins, and suites. Every room is outward-facing, revealing beautiful ocean views, and 13 cabins and suites have floor-to-ceiling glass doors and private balconies. *National Geographic Gemini* is also home to the largest suite in our Galápagos fleet, featuring a separate living room, floor-to-ceiling windows, and two balconies—one of which measures 195 square feet and holds a private jacuzzi.

Enjoy the outdoors on the upper deck, where a whirlpool hot tub and a windowed fitness center and spa meet your wellness needs. An outdoor café accommodates all guests in a single open seating, as does the indoor restaurant. The open, windowed lounge features a large bar, well-stocked library, and plenty of seating space for naturalist presentations.

National Geographic Gemini is geared for discovery of the archipelago and marine reserve, carrying a fleet of quick-to-deploy Zodiacs, a glass-bottom boat, and kayaks and stand-up paddleboards. It is also stocked with snorkeling gear for all guests, including masks, fins, and shortie wetsuits.



Above: Category 6 Suite balcony with seating area; outdoor café.



LEARN MORE: Read about this fully equipped expedition ship and her wide array of accommodations.



National Geographic Islander II

National Geographic Islander II is an intrepid expedition vessel with the spirit and soul of a private yacht. She is outfitted with 26 supremely comfortable staterooms and suites as well as sleek shared spaces that emphasize indoor-outdoor living.

Al fresco dining options and an open-air observation deck give you the exhilarating feeling of being out on the water with all the convenience and comfort of graciously appointed living spaces. As we sail the islands, enjoy a sustainably sourced meal in a shady spot on deck, sip a cool beverage in a hammock, or watch for wildlife through panoramic windows in the lounge. Every gathering area and individual accommodation emanates an authentic sense of place through island-inspired art and décor, while dedicated wellness areas—including a spa treatment room, top-deck plunge pool, sauna, and fitness center—encourage travelers to tap into the natural rhythms of the archipelago.

National Geographic Islander II is stocked with expedition tools that invite meaningful encounters in one of the planet's most fascinating archipelagos, including a Science Hub with NOAA-Duke equipment for active oceanography research. The ship's fleet of Zodiacs includes a custom-designed glass-bottom vessel that allows for underwater exploration without going beneath the water's surface. Travelers can change in and out of their gear in the spacious marina, equipped with dedicated snorkeling equipment for each guest.



Clockwise from top: Lounge with full service bar and facilities for films, slideshows, and presentations; spacious Category SU Stateroom; indoor-outdoor dining with Ecuadorian flair served in a single, unassigned seating in the Patio Café.



TAKE A VIRTUAL TOUR: Fly through the ship's elegant decks and staterooms on a virtual tour unlike any other.





National Geographic Endeavour II

Born in the cold waters of Patagonia, *National Geographic Endeavour II* was built for heavy seas. Now permanently stationed in Galápagos, she comfortably sails the Equator.

A stem-to-stern refit when she repositioned to the tropics meant she could be crafted to perfectly accommodate the Lindblad Expeditions-National Geographic style of travel. Where she previously carried 136 passengers, she now accommodates just 96 guests in 52 thoughtfully appointed cabins. She is exceptionally nimble and maneuverable, with a shallow draft for up-close discovery, exceptional viewing from all public spaces, an expansive open-air observation deck, and large windows in cabins and suites. Her exploration tools include a glass-bottom boat, underwater cameras, and video microscope, as well as kayaks, stand-up paddleboards, and dedicated snorkeling gear for each guest.

Guests have described being aboard *National Geographic Endeavour II* as feeling like a cross between a grand floating hotel and scientific research vessel. She is comfortable and welcoming to solos, groups, and kids of all ages—and she is equipped for the in-depth explorations that makes Galápagos the trip of a lifetime.



Clockwise from top: Spacious dining room with a sociable, informal atmosphere and Ecuadorian flair; lounge with full service bar and state-of-the-art facilities for films, slideshows, and presentations; Category 1 cabin.



LEARN MORE: Our Suite Exclusives package gives guests staying in eligible cabins access to an array of amenities and perks.

A Travel Experience Five Decades in



In the 1960s, the Galápagos Islands were known the world over as the inspiration for Charles Darwin's theory of evolution, but the destination had only been seen by a privileged few. Explorer Lars-Eric Lindblad was lured by the prospect of witnessing Darwin's famous finches and other enchanting creatures that illustrate the power of evolution in isolation.

Astounded by what he found there, Lindblad recognized the potential for tourism in the archipelago and felt compelled to share its wonders—and so, he launched the first international expedition cruise to Galápagos in 1967. He had a vision for travel that was firmly grounded in sustainability, long before the green travel movement was mainstream.

During these early days, Lindblad engaged local scientists, conservationists, and residents whose lives and livelihoods were intertwined with their wild surroundings. They helped establish our tenets for responsible travel, and today, local *Galapagueños* serve as naturalist guides, guest speakers, and hosts for island excursions, providing the most authentic experience possible.

Lindblad's vision for responsible Galápagos travel has stood the test of time; many of the guidelines he helped establish are still followed by operators today. And as the archipelago faces the challenges of the 21st century, Lindblad Expeditions-National Geographic has strengthened its commitment to conservation;

the Making



together with our guests, we have contributed more than \$10 million to preserve Galápagos habitats and communities.

Like our founder before us, we believe in the power of seeing the Galápagos firsthand. With two new ships in our Galápagos fleet—*National Geographic Gemini* and *National Geographic Delfina*—we provide guests with an array of options so they can choose their ideal Galápagos experience.

These are voyages born from the relationships we have built and the knowledge we have gained over 50 years of exploration—and they celebrate every part of this special place, from the wild sea to the stars above and the volcanic landscapes and vibrant communities in between. Whatever experience you

seek in the Galápagos, you'll find it aboard our fleet, where you'll be privy to the best-kept secrets of this world-renowned destination.

Clockwise from top left: Lars-Eric Lindblad exploring the Galápagos in 1968; Galápagos researchers track a deep-sea camera; Naturalist Ixora Berdonces interprets Galápagos habitats for guests; the Charles Darwin Research Station; an aerial view of National Geographic Islander II; chefs from National Geographic Endeavour II source vegetables from a local farm; guests board Zodiacs in preparation for exploration; Sven Lindblad poses with students at the Tomás de Berlanga school on Santa Cruz; our early explorations of the iconic Pinnacle Rock.

“The name Lindblad has a special place in Galápagos. In the early stages of establishing the Ecuadorian park service, his tourism venture started injecting ideas, funds, and new ways of reporting conservation science and management.”

—Dr. Arturo Izurieta, Galápagos National Park Director

National Geographic Global Explorers Program

Nurture Their Passion For Exploration

Something magical happens when you introduce a child to the wonders of Galápagos: new and surprising passions begin to take hold. Our voyages in the archipelago are filled with exciting discoveries that spark curiosity and conversation, from wild encounters with giant tortoises to impromptu performances from blue-footed boobies engaged in an elaborate courtship dance. Moments like these are especially meaningful when complemented with the learning opportunities in our exclusive National Geographic Global Explorers program.

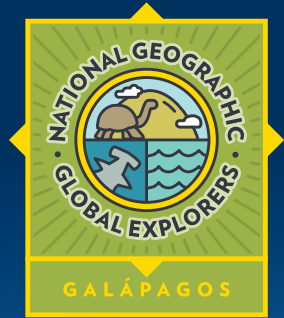

Developed in conjunction with National Geographic Education, this hands-on, interactive program teaches kids and teens 18 and under how to explore like scientists and tell the stories of the archipelago's legendary wildlife. Young adventurers are led by certified field educators who are experts at using the Galápagos as a natural classroom.

Kids hone their observation skills and learn to share their experiences through photographs, videos, drawings, and more. With a range of activities to choose from, such as snorkeling with sea lions or earning a Zodiac driver's 'license,' this flexible program encourages young travelers to explore their own interests, whether it's marine biology, geology, or photography.



Program Highlights

Wildlife Watching

Zip along shore in a Zodiac, then hike in search of Galápagos wildlife, like barking sea lions and marine iguanas. Snap photos with your smartphone and jot notes in your official National Geographic Global Explorers Field Notebook.

Microscopic Exploration

Drop a net over the side of your Zodiac to collect plankton, and check it under a video microscope to see how it looks and moves.

Video Shoots

Get tips from your certified photo instructor on how to create impressive slow-motion and timelapse videos, then test out your new skills in the field.

License to Explore

Learn to operate a Zodiac and earn your 'driver's license.' (Sorry adults, kids only.)

Check Your List

Head to the ship lounge to review the wildlife you saw and mark it in your notebook. Include creatures big and small—whether it's a lava lizard or a giant tortoise. Tally your points to keep track of your progress on becoming certified as a National Geographic Global Explorer.



New Friends and Fun Adventures

Meet up with your new friends for fun activities with your certified field educator. Depending on the day, it might be a pizza dinner, games in the lounge, a special hike, or other surprises.

Eyes to the Night Sky

Head to the top deck to watch the stars come out as the sun goes down. Find and record constellations with the help of your certified field educators.

INSPIRE THEIR INNER EXPLORER: Visit expeditions.com/globalexplorers for program details.

The Galápagos Islands



ISABELA

Toast crossing the Equator at Volcán Ecuador, the northernmost of the island's six great shield volcanoes. Keep an eye out for whales and dolphins as you ply these rich waters, once the haunt of whalers and pirates.



SANTIAGO

Explore tide pools and search for fur seals in quiet grottos on this island where a coastal forest and spectacular geological formations are high points.



FERNANDINA

One of the most active oceanic volcanoes in the world, it's home to the strange flightless cormorant and the largest population of marine iguanas.



HISTORIC MILESTONE IN GALÁPAGOS

Established in 2022, the Hermandad Marine Reserve expanded the Galápagos Marine Reserve by almost 50 percent and extends northeast to Colombia, Costa Rica, and Panama.

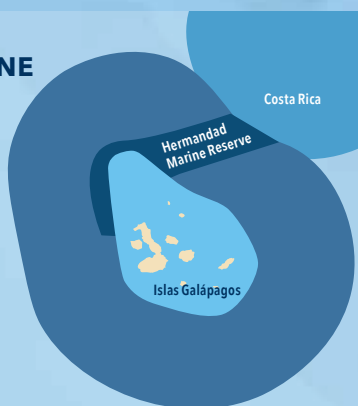

FLOREANA

Follow a trail along a rose-pink lagoon across Punta Cormorant. Visit Post Office Bay, founded by 18th-century whalers, on this mysterious island with an intriguing human history.



BARTOLOMÉ

Climb to the summit of this volcanic wonderland, then snorkel and swim from a golden beach.



NORTH SEYMOUR

Encounter nesting frigatebirds, plus land and marine iguanas, and enjoy a beautiful coastal walk.

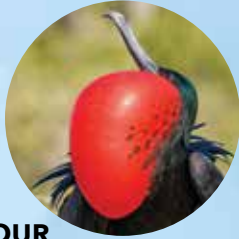

SOUTH PLAZA

Sea lions greet us at South Plaza, an uplifted volcanic block carpeted in salt-loving succulents and teeming with wildlife.



SANTA CRUZ

Call at Puerto Ayora, the largest town and headquarters of both the Charles Darwin Research Station and Galápagos National Park. Head to the lush, green highlands to see giant tortoises roaming in the wild.



RÁBIDA

Snorkel along the rocky coastline among schools of tropical fish and curious sea lions before landing on a brilliant red beach to look for both land and sea birds.



GENOVESA

Sail to the remote northern realm of the Galápagos, a seabird paradise bathed in warm tropical waters.



SAN CRISTÓBAL

Search for red-footed boobies and the endemic mockingbird and lava lizard—found only on this easternmost island. Explore Baquerizo Moreno, where sea lion colonies thrive in the middle of town.



ESPAÑOLA

Home to swallow-tailed gulls, Española mockingbirds, Nazca boobies and, seasonally, the world's only population of waved albatross.



Exploring Galápagos: One Week Sailing the Islands



10 DAYS / FROM \$6,605pp
2024-2027: Weekly expeditions
year-round, departing Fridays
National Geographic Endeavour II
and *National Geographic Gemini*

Visit expeditions.com/sailgala for itinerary detail, extensions, and current rates

HIGHLIGHTS

- Immerse yourself with a **full week in Galápagos** on our classic experience.
- **Walk among wildlife unfazed by your presence.** Loiter on beaches with sea lions, marvel at huge colonies of marine iguanas, and see nesting seabirds.
- **Snorkel with sea lions**, turtles, and abundant fish in the protected waters of the Galápagos Marine Reserve.
- Adventure by kayak, paddleboard, glass-bottom boat, and Zodiac.
- **Observe giant Galápagos tortoises** in the wild on an excursion in the highlands of Santa Cruz.
- Explore alongside a **National Geographic Photography Expert** on dedicated photography departures, and join an optional pre-voyage extensions to the picturesque Ecuadorian Amazon.
- On our Tropical Andes & Colonial Quito extension, **explore Quito's UNESCO-designated historical center** and settle into Mashpi Lodge, nestled in a private reserve in one of the world's top biodiversity hotspots.

National Geographic Endeavour II and Kicker Rock.



SPECIAL OFFERS

Book by Nov. 1, 2024 for early booking offers

- Lock in rates for 2026-2027
- Save \$1,000 per child up to age 22
- Save up to 20% on back-to-back voyages
- Book two or more voyages and save 10%
- Save 5% when you book two or more cabins

Book by Oct. 31, 2024 for round-trip

Galápagos air included up to \$1,200pp plus internal air. Select departures only.

See page 34 for details.



Kayakers observe a blue-footed booby perched on a volcanic shoreline.

Galápagos by Catamaran: An Intimate Voyage



10 DAYS / FROM \$9,940pp
2025-2027: Weekly expeditions
year-round, departing Fridays
National Geographic Delfina

Visit expeditions.com/galavoyage for itinerary details, extensions, and current rates

HIGHLIGHTS

- **Encounter Galápagos wildlife up close** on an exclusive catamaran with 16 guests and two veteran expedition staff to guide you over a full week in the islands.
- **Adventure by kayak, paddleboard, and Zodiac** on waters rich in marine life.
- **Discover wildlife unfazed by your presence:** lounge on beaches with sea lions, walk among huge colonies of marine iguanas, and delight at the antics of nesting seabirds from ship and shore.
- **See more of Ecuador** with a stay in Quito, or venture to Mashpi Lodge in the tropical Andes.



SPECIAL OFFERS

Book by Nov. 1, 2024 for early booking offers

- Lock in rates for 2026-2027
- Save \$1,000 per child up to age 22
- Save up to 20% on back-to-back voyages
- Book two or more voyages and save 10%
- Save 5% when you book two or more cabins

Book by Oct. 31, 2024 for round-trip Galápagos air included up to \$1,200pp plus internal air. Select departures only. See page 34 for details.

Wild Galápagos Escape



7 or 8 DAYS / FROM \$6,864pp
2024-2027: Expeditions year-round,
departing Thursdays and Saturdays
National Geographic Islander II

Visit expeditions.com/wildgala7 for itinerary details, extensions, and current rates

HIGHLIGHTS

- Travel aboard an expedition ship that feels like a private yacht, with only **26 staterooms and suites**.
- Maximize your time in the islands with multiple exploration options every day.
- **Snorkel and kayak in rich waters** among shimmering fish, sea turtles, penguins, and playful sea lions.
- **Walk among wildlife colonies** unfazed by your presence.
- Relax at **Hotel Del Parque**, a serene tropical refuge and Relais & Chateaux property along the banks of the river in Guayaquil. Or opt for Casa Gangotena in the heart of Quito. Additional nights are available for further exploration.
- **Extend your expedition** at the famed Otavalo market.



SPECIAL OFFERS

Book by Nov. 1, 2024 for early booking offers

- Lock in rates for 2026-2027
- Save \$1,000 per child up to age 22
- Save up to 20% on back-to-back voyages
- Book two or more voyages and save 10%
- Save 5% when you book two or more cabins

Book by Oct. 31, 2024 for round-trip Galápagos air included up to \$1,200pp plus internal air. Select departures only.
See page 34 for details.

Sea lion, Galápagos.





New Expedition Duration: Starting in 2026, guests will enjoy an extra night in Cusco.

Machu Picchu.

Wild Galápagos & Peru Escape

11 or 12 DAYS / FROM \$8,986pp
2024-2027: Expeditions year-round, departing Fridays
National Geographic Islander II

Visit expeditions.com/wildgalaperu for itinerary details, extensions, and current rates

HIGHLIGHTS

- Experience **two iconic destinations** in one fast-paced and active expedition.
- Linger into the late afternoon at fabled **Machu Picchu**, introduced to the world by Hiram Bingham in the April 1913 issue of *National Geographic* magazine.
- Spend two nights in the **Sacred Valley of the Inca** and a night in **Cusco**, imperial capital of the Inca.
- Maximize your time in **Galápagos** with multiple exploration options every day.
- Sail into a **flooded caldera** and visit a birdwatcher’s paradise.
- **Extend your expedition** in vibrant, cosmopolitan Lima or in UNESCO-designated Quito and the famed Otavalo market.

NEW! In 2026, our Wild Galápagos and Peru Escape will be a 12-day program, adding an additional night in Cusco. Departs Thursdays.



SPECIAL OFFERS

Book by Nov. 1, 2024 for early booking offers

- Lock in rates for 2026-2027
- Save \$1,000 per child up to age 22
- Save up to 20% on back-to-back voyages
- Book two or more voyages and save 10%
- Save 5% when you book two or more cabins

Book by Oct. 31, 2024 for round-trip Galápagos air included up to \$1,200pp plus internal air. Select departures only. See page 34 for details.

Combine Expeditions and Enjoy Exclusive Savings

Make the most of your time in South America by combining your Galápagos voyage with either or both of two immersive expeditions in the region: an exploration of the Peruvian Andes and magnificent Machu Picchu, and a voyage along the Upper Amazon. Or stay in the Galápagos for back-to-back departures of your voyage, enjoying an extended experience that allows you to see even more of this fascinating archipelago. When you book consecutive journeys with us before November 1, 2024, you can save up to 20%.



Add Machu Picchu and Peru's Land of the Inca

16 DAYS | LAND PROGRAM + GALÁPAGOS ABOARD NATIONAL GEOGRAPHIC GEMINI, NATIONAL GEOGRAPHIC DELFINA OR NATIONAL GEOGRAPHIC ENDEAVOUR II

FROM: \$12,643pp

Journey to the Galápagos and embark on a voyage through the archipelago aboard *National Geographic Gemini*, *National Geographic Delfina* or *National Geographic Endeavour II*. Then follow Peru's Sacred Valley from Cusco to the fabled Machu Picchu, encountering archaeological relics of the Inca and the vibrant culture of the Andes. Explore three UNESCO World Heritage sites—capital city Lima, colonial Cusco, and Machu Picchu—and watch a weaving demonstration with a National Geographic Grantee who has kept Andean textile traditions alive.



Machu Picchu.

Add Upper Amazon Aboard the *Delfin II*

18 DAYS | GALÁPAGOS ABOARD NATIONAL GEOGRAPHIC GEMINI, NATIONAL GEOGRAPHIC DELFINA, OR NATIONAL GEOGRAPHIC ENDEAVOUR II

FROM: \$14,487pp

Combine your Galápagos expedition with a voyage on the Upper Amazon and explore pristine rainforest aboard the elegant riverboat *Delfin II*. Glide into narrow tributaries by skiff and kayak to get a closer look at unusual plants and wildlife, discovering enormous ceiba trees and forests flooded with mirror-like waters. Watch for monkeys and macaws in the canopy and pink dolphins splashing in the river, and spend time in local communities along the river that we support through Minga Peru.



Delfin II at sunset.

Back-to-Back Galápagos Voyages

Set sail on any Galápagos voyage and stay on board for consecutive departures to explore even more of the archipelago. Following Galápagos National Park regulations, ships cannot visit an individual visitor site more than once every two weeks; we operate a 14-night schedule with new sites every day, an initiative aimed at spreading visitors across the archipelago for a more intimate experience. Booking back-to-back departures of your voyage allows you to see more islands and experience even more of the Enchanted Isles.

**Rates are per person based on double occupancy and are subject to change.*



Guests embark on a Zodiac ride in Galápagos.

Extend Your Experience

Our Galápagos expeditions offer pre- and post-voyage extensions in intriguing destinations across Ecuador and Peru. Join local experts on one of these curated, land-based experiences, each designed to immerse you more deeply in the region's rich history, culture, and nature.

Living with Nature, Galápagos

A three-day cultural immersion on the Island of Santa Cruz

PRE-VOYAGE | WILD GALÁPAGOS ESCAPE
4 DAYS/3 NIGHTS FROM \$2,245

Guests traveling on select departures of *National Geographic Islander II* have the option to add a four-day pre-voyage extension spending three days on the island of Santa Cruz, the most populated isle in the archipelago and home to Galápagos National Park head-quarters and the Charles Darwin Research Station.

Visit with local farmers who provision our Galápagos fleet, meet researchers and beneficiaries of the Lindblad Expeditions-National Geographic Fund, explore the highlands, and enjoy time with the people who call Galápagos home on an exploration of life and conservation in this iconic UNESCO World Heritage site.

You'll settle into a comfortable hotel for two nights and set out on excursions and activities led by a veteran naturalist guide from the island, discovering places like the beautiful beach of Tortuga Bay and agricultural zones where farmers make accommodations for creatures such as giant tortoises. You'll also sample local cuisine at festive meals featuring local chocolates, cheeses, and more. Experienced divers have the option to head out on day trips with our local scuba partner (at additional cost, by prior arrangement).



Giant tortoise in the highlands of Santa Cruz.



Galápagos flower farmers sell edible begonias to the Lindblad Expeditions-National Geographic fleet.

See Quito

Arrive a day early and explore Ecuador's beautifully preserved colonial capital

**PRE-VOYAGE | EXPLORING GALÁPAGOS: ONE WEEK
SAILING THE ISLANDS AND WILD GALÁPAGOS ESCAPE
3 DAYS/2 NIGHTS FROM \$449pp**

Experience Quito, a UNESCO World Heritage site with dazzling colonial churches and bustling traditional markets, from our base at the Swissôtel Quito in the vibrant La Floresta neighborhood. We'll focus our explorations on the Centro Histórico, a vibrant district where the city's colonial legacy blends with contemporary Andean culture. This extension adds just one night to your voyage, giving you time to rest and relax and to see the city.



New

Tropical Andes & Colonial Quito

Featuring Mashpi Lodge, set in a 6,000-acre rainforest reserve

**PRE-VOYAGE | EXPLORING GALÁPAGOS: ONE WEEK
SAILING THE ISLANDS
6 DAYS/5 NIGHTS FROM \$2,690pp**

After touring Quito's enchanting UNESCO World Heritage-listed colonial center, explore from your base at Casa Gangotena, a Relais & Châteaux property, and immerse yourself in the Ecuadorian Chocó—one of the world's top biodiversity hotspots—during a stay at the exquisite Mashpi Lodge, set in the midst of the tropical forest.



Taste of Lima

Relax and explore vibrant, cosmopolitan Lima

**PRE-VOYAGE | WILD GALÁPAGOS & PERU ESCAPE
3 DAYS/2 NIGHTS FROM \$440pp**

Discover vibrant, cosmopolitan Lima on this pre-voyage extension, featuring two nights at the classic Lima Country Club Hotel in fashionable San Isidro. Explore the UNESCO-designated heart of the colonial center and sample the city's celebrated cuisine.



**Rates are per person based on double occupancy and are subject to change.*

Elegant Hotel Accommodations

Settle into one of these superb accommodations and get to know vibrant South American cities while enjoying time to take advantage of luxurious on-site amenities. Add extra nights at these hotels and stay longer to explore more.

Swissôtel

Quito

Your home base for our three-day *See Quito* extension is the sleek Swissôtel, located in the fashionable and centrally located Floresta neighborhood. Convenient to the city's best restaurants and shops, this full-service hotel has an excellent sport club and spa, and is home to Foresta, Chef Rodrigo Pacheco's conservation-focused restaurant. You may book additional nights or swap your included expedition hotel on any of our voyages.



Casa Gangotena

Quito

Travelers on our *Tropical Andes & Colonial Quito* extension stay in this stunning restored family mansion on Plaza San Francisco in the heart of the UNESCO-designated colonial center. The 31-room Relais & Châteaux boutique hotel blends classic architecture and antiques with contemporary interior design, fine furnishings, and quintessential comforts. You may book additional nights or swap your included expedition hotel for Casa Gangotena on any of our voyages (at additional cost).



Country Club Lima Hotel

Lima

Spend two nights at this 1920s historic landmark in fashionable San Isidro during our *Taste of Lima* extension. With all the amenities of a five-star hotel—including a spa and fitness center, celebrated public spaces, and spacious suites—the hotel is an excellent base to explore the city. In partnership with the Pedro de Osma Museum, each of the hotel's rooms and public areas showcases colonial artwork.

CURATE YOUR GALÁPAGOS EXPERIENCE: We offer a variety of ways to add extra days in Guayaquil, Quito, or Lima to your Galápagos adventure. Explore our travel opportunities at [expeditions.com/galaoptions](https://www.expeditions.com/galaoptions)

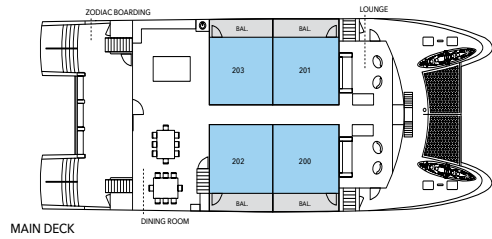
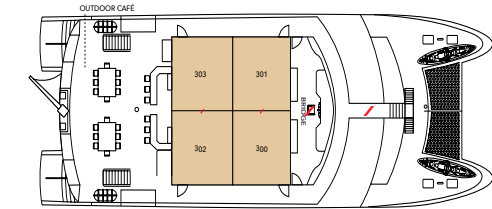
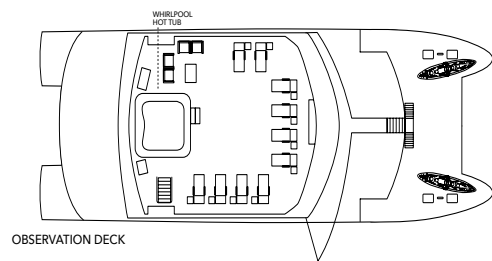

/ indicates adjoining cabins

Clockwise from top: National Geographic Delfina; Category 4 stateroom; Outdoor Café.

National Geographic Delfina

CAPACITY: 16 guests in 8 Staterooms.
REGISTRY: Ecuador. **OVERALL LENGTH:** 98 feet.

The ultimate, intimate Galápagos expedition will launch in February 2025.

PUBLIC SPACES: The open-air observation deck provides 360-degree views and features a whirlpool hot tub and lounge chairs to take in your surroundings. On the wrap-around upper deck, dine al fresco at the stern and enjoy spectacular island views from the bow. The outdoor café accommodates all guests in a single unassigned seating. The lounge on the main deck hosts presentations and recaps. Zodiac Boarding and gearing up area for snorkeling and excursions are also located on the main deck.

MEALS: Indoor-outdoor dining with Ecuadorian flair served in a single, unassigned seating in the outdoor café and dining room. The atmosphere is sociable and informal, and menus feature local, sustainable ingredients.

ACCOMMODATIONS: 16 guests accommodated in 8 staterooms on two decks. Category 4 staterooms can be reserved as interconnected, starboard, and port. Category 5 staterooms have a private balcony. All accommodations are bright with outside views, convertible queen/twin beds, ample closets, and large bathroom with plush bathrobes and stand-up showers. In addition, staterooms have a stocked mini-bar, and a flat-screen TV.

EXPEDITION TOOLS: Zodiacs for landings and cruising, a fleet of kayaks and stand-up paddleboards, snorkel gear for adults and children.

SPECIAL FEATURES: Two veteran Lindblad Expeditions-National Geographic expedition staff: an Expedition Leader and National Geographic certified photo instructor, both licensed naturalists. Staff are certified as Field Educators to offer the National Geographic Global Explorers program for kids and teens, snorkel or kayak instruction, Wi-Fi access. Note: This vessel does not carry a medical professional. Please call with questions.

CAT 4: Upper Deck– 172 sq.ft. with large window, convertible queen/twin beds, desk, ample closets, and large bathroom with plush bathrobes and stand-up showers #300, 302, 301, 303

CAT 5: Main Deck– 172 sq.ft. with two large windows, private balcony, convertible queen/twin beds, desk, ample closets, and large bathroom with plush bathrobes and stand-up showers #200, 202, 201, 203

CONNECTING SUITES: #300/301, 302/303

SEE MORE ONLINE: Learn more about *National Geographic Delfina* at expeditions.com/delfina



Clockwise from top: National Geographic Gemini; Category 6 stateroom; upper deck with whirlpool hot tub.

National Geographic Gemini

CAPACITY: 48 guests in 27 outside cabins.

REGISTRY: Ecuador. **OVERALL LENGTH:** 296 feet.

Fully equipped Galápagos expedition ship for 48 guests launching in March 2025.

PUBLIC AREAS: The upper deck features an outdoor shower, whirlpool hot tub with adjacent shaded seating area and a windowed fitness center and spa is perfect for relaxing. The outdoor café accommodates all guests in a single seating, and the expansive lounge hosts presentations and recaps, and features a well-stocked comfortable bar; Global Gallery and reception are all located on the lounge deck. Zodiac boarding and gearing up area for snorkeling and excursions and the dining room with flexible seating for everyone aboard are located on the marina deck.

MEALS: Served in a single, unassigned seating in a sociable, informal atmosphere with Ecuadorian flair in the dining room and outdoor café.

CABINS: All face outside with large windows, and feature single beds that convert to a queen, with private facilities and climate control, nightstands, desk, and storage. Three sets of cabins with a connecting door. Thirteen cabins have private balconies, including two suites with large private balconies, one suite with private jacuzzi on deck.

EXPEDITION EQUIPMENT: Zodiacs, glass-bottom boat, kayaks and stand-up paddleboards, snorkel gear and wetsuits for both adults and children, video microscope and underwater video camera.

SPECIAL FEATURES: Lindblad Expeditions-National Geographic certified photo instructor, shipboard doctor, National Geographic Global Explorers family program, snorkel and kayak instruction, Wi-Fi access, laundry service, Global Gallery.

WELLNESS: LEXSpa and fitness center, exercise classes, and wellness specialist.

SEE MORE ONLINE: Learn more about *National Geographic Gemini* at expeditions.com/gemini

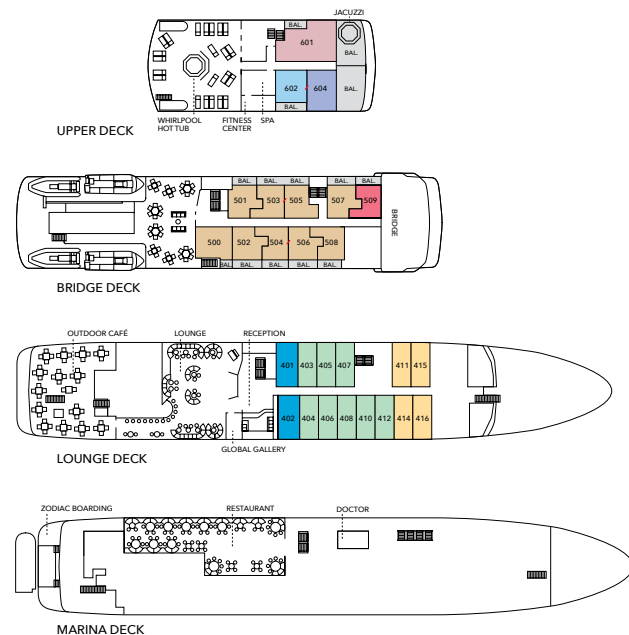

↗ indicates adjoining cabins

CATEGORY 1: Lounge Deck #411, 414, 415, 416 Forward cabins, outside facing with a large window.

CATEGORY 2: Lounge Deck #403-408, 410, 412 Outside facing with a large window.

CATEGORY 4: Bridge Deck #500-508 Outside facing with floor-to-ceiling glass doors, 50-square-foot balcony with seating.

CATEGORY 5: Upper Deck #602 Outside facing with floor-to-ceiling glass doors, 50-square-foot balcony with seating.

CATEGORY 6: Upper Deck #604 Forward facing with floor-to-ceiling glass doors, 195-square-foot forward-facing balcony with seating.

CATEGORY 7: Upper Deck #601 Forward facing suite with separate living room, two bathrooms, with floor-to-ceiling glass doors and 195-square-foot forward-facing balcony with seating and private jacuzzi on deck. Bedroom with 50-square-foot side balcony.

CATEGORY 2 SOLO: Lounge Deck #401 and 402 Outside facing with a large window.

CATEGORY 5 SOLO: Bridge Deck #509 Outside facing with floor-to-ceiling glass doors, 50-square-foot balcony with seating.

CONNECTING CABINS: #504/506, 503/505, 602/604

TRIPLE OCCUPANCY: #500, 503, 601, 604.

SHARED ACCOMMODATIONS: Shares can be arranged at the double occupancy rate in Category 1.

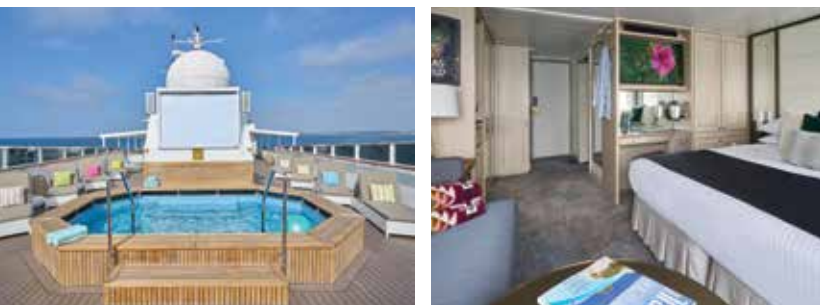

Clockwise from top: National Geographic Islander II; spacious category SU stateroom; plunge pool.

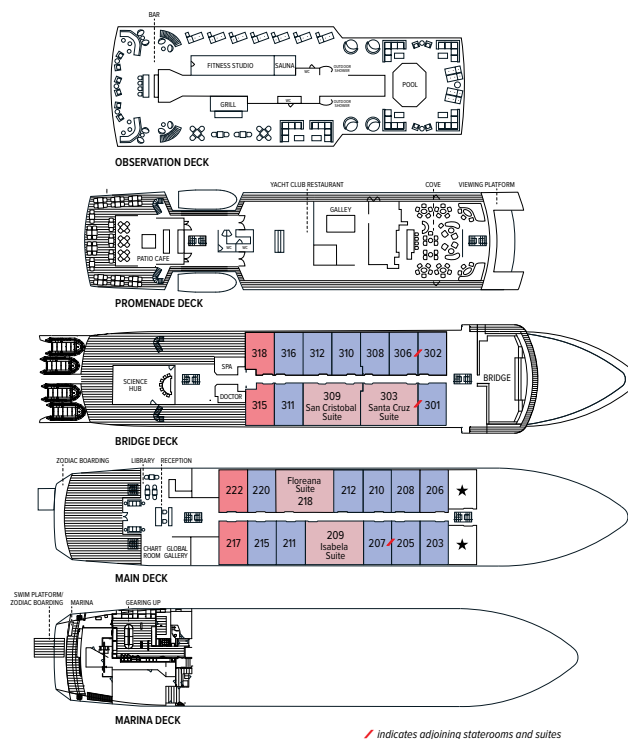

National Geographic Islander II

CAPACITY: 48 guests in 26 staterooms and suites.

REGISTRY: Ecuador. **OVERALL LENGTH:** 280 feet.

This all-suite vessel, newly refitted for Galápagos, launched in August 2022.

PUBLIC SPACES: Expansive Observation Deck with grill and bar, fitness center, sauna, outdoor showers, and plunge pool; Outdoor Patio Café and Yacht Club Restaurant; Cove lounge newly outfitted for state-of-the-art presentations for all guests, with full-service bar; Forward viewing platforms and expansive surrounding teak decks throughout the ship; Science Hub with interactive video display, onboard television network, photo kiosks and versatile lab facilities; Reception, chart room, Global Gallery, library and beverage center. Newly expanded marina with gearing up and snorkel areas, Zodiac boarding, and swim platform.

MEALS: Indoor-outdoor dining with Ecuadorian flair served in a single, unassigned seating in the Patio Café and Yacht Club. The atmosphere is sociable and informal, and menus feature local, sustainable ingredients.

ALL SUITES: 48 guests accommodated in 26 staterooms and suites spread across two decks with connecting, solo, and triple options; four Islander Suites with separate living area, table and chairs, and bath with bathtub. The Santa Cruz Suite can be reserved as a Family Suite with connecting double suite. All accommodations have large windows, convertible king/twin beds, ample closets, marble double-sink bathrooms, Wi-Fi access, stocked mini-bar, flat screen television with shipboard network.

EXPEDITION TOOLS: Zodiac Mark V boats for landings and cruising, custom-built glass bottom Zodiac, fleet of kayaks and stand-up paddleboards, snorkel gear for adults and children, science hub equipped for oceanography, video editing and screenings, video microscope, remote cameras.

SEE MORE ONLINE: Learn more about *National Geographic Islander II* at expeditions.com/islanderii

SPECIAL FEATURES: Shipboard doctor, undersea specialist, National Geographic certified photo instructor, National Geographic Global Explorers family program led by National Geographic certified field educators, suites for science and conservation (indicated as ★ on deck plan) reserved for invited Galápagos community members, researchers, educators, and storytellers.

WELLNESS: Wellness specialist, fitness center, yoga space, spa with quartz massage table, sauna.

STATEROOM: Bridge & Main Deck—280 sq. ft. with two large windows, seating area with sofa, lounge chair #203-207, 211, 215, 206-208, 210-212, 220, 301, 311, 302, 306-308, 310-312, 316

ISLANDER SUITE: Bridge & Main Deck—515 sq. ft. with four windows, separate living room with sofa, two lounge chairs, large bath with rain shower and tub #209, 218, 303, 309

SOLO STATEROOM: Bridge & Main Deck—280 sq. ft. with two large windows, seating area with sofa, lounge chair #217, 222, 315, 318

CONNECTING STATEROOMS: #205/207, 302/306

FAMILY SUITE: Santa Cruz Islander Suite #303/301

TRIPLE OCCUPANCY: Staterooms #312, 316, and Islander Suites (#209, 218, 303, 309). With sofa made up as third bed. Third person rates are one-half the double occupancy rate.

SHARED OCCUPANCY: Shares can be requested for staterooms at double occupancy rate.

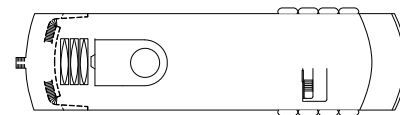

OBSERVATION DECK

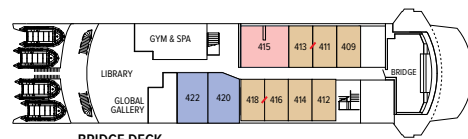

BRIDGE DECK

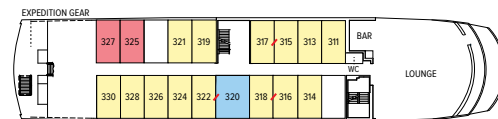

LOUNGE DECK

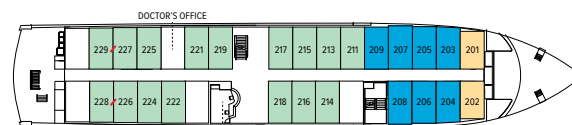

UPPER DECK

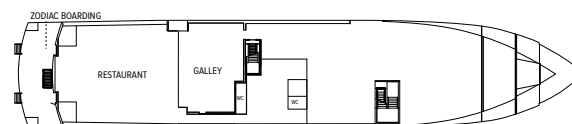

MAIN DECK

↗ indicates adjoining cabins

Clockwise from top: National Geographic Endeavour II features 52 cabins accommodating 96 guests; Category 1 cabin; dining room.

National Geographic Endeavour II

CAPACITY: 96 guests in 52 outside cabins.

REGISTRY: Ecuador. **OVERALL LENGTH:** 236 feet.

PUBLIC AREAS: Forward lounge and bar accommodating all guests for presentations and gatherings, restaurant, large library with Mac kiosks, open-air observation deck, underwater gear area and dual Zodiac boarding platform, and "open Bridge," where guests can meet the captain and officers and learn about navigation.

MEALS: Served in a single, unassigned seating in a sociable, informal atmosphere with Ecuadorian flair.

CABINS: All face outside with large windows, and feature single beds that convert to a queen. With private facilities and climate control, nightstands, desk, and storage. Seven sets of cabins with a connecting door.

EXPEDITION EQUIPMENT: Zodiacs, glass-bottom boat, kayaks and paddleboards, snorkel gear and wetsuits for both adults and children, video microscope and underwater video camera.

SPECIAL FEATURES: Lindblad Expeditions-National Geographic certified photo instructor, shipboard doctor, National Geographic Global Explorers family program, snorkel instruction, Wi-Fi access, laundry service, Global Gallery.

WELLNESS: LEXSpa and fitness center, exercise classes, and wellness specialist.

CATEGORY 1: Upper Deck, #201, 202 Cabins face outside with a large window.

CATEGORY 2: Upper Deck #211, 213-219, 221, 222, 224-229 Cabins face outside with a large window.

CATEGORY 3: Lounge Deck #311, 313-319, 321, 322, 324, 326, 328, 330 Cabins face outside with a large window.

CATEGORY 4: Bridge Deck #409, 411-414, 416, 418 Cabins face outside with a large window.

SUITE A: Lounge Deck, Mid-Ship #320 Suites face outside with two windows, larger bath, double closet. Connecting door to #322.

SUITE B: Bridge Deck, Mid-Ship #420, 422 Suites face outside with two floor-to-ceiling windows, larger bath, double closet and convertible sofa for a third person.

SUITE C: Bridge Deck, Mid-Ship #415 Suites face outside with two large windows, larger bath, separate sitting area with convertible sofa for a third person and lounge chair, coffee table and extra closet space.

CATEGORY 2 SOLO: Upper Deck #203-209 Cabins face outside with a large window.

CATEGORY 3 SOLO: Lounge Deck #325, 327 Cabins face outside with a large window.

CONNECTING CABINS: #226/228, 227/229, 315/317, 316/318, 320/322, 411/413, 416/418

TRIPLE OCCUPANCY: #224, 225, 326, 328 with fold-down upper third bunk, Suites B and C with convertible sofa bed. Third person rates are one-half per person double occupancy rate.

SHARED ACCOMMODATIONS: Shares can be arranged at the double occupancy rate in Categories 1 and 2.

SEE MORE ONLINE: Learn more about *National Geographic Endeavour II* at expeditions.com/endeavourii

Lindblad Expeditions-National Geographic



National Geographic Delfina

Launches Feb. 2025

Guest Capacity

16

Cabins

8

Solo Cabins

Connecting Cabins

4

Balcony Cabins

4

Spa Facilities

Fitness Center

Diving Options

Exclusive Family Program

●

Bar Tab and Wi-Fi Included

●

Itinerary and Duration

Galápagos by Catamaran:
An Intimate Voyage (10 day),
Galápagos by Catamaran + Machu Picchu
and Peru's Land of the Inca (16 day)

Extensions

Tropical Andes & Colonial Quito Pre-Voyage,
See Quito Pre-Voyage



National Geographic Gemini

Launches Mar. 2025

48

27

3

6

13

●

●

●

●

Exploring Galápagos: One Week Sailing
the Islands (10 day), Exploring Galápagos:
One Week Sailing the Islands + Machu Picchu
and Peru's Land of the Inca (16 day)

Tropical Andes & Colonial Quito Pre-Voyage,
See Quito Pre-Voyage

Fleet in the Galápagos Islands



National Geographic Islander II
Launched 2022

48

26

4

6

●

●

●

●

Wild Galápagos Escape (8 and 7 day),
Wild Galápagos and Peru Escape
(12 and 11 day)

Quito & Otavalo Post-Voyage, See Quito
Pre-Voyage, Taste of Lima Pre-Voyage,
Living with Nature Galápagos Pre-Voyage



National Geographic Endeavour II
Refurbished 2016

96

52

9

14

●

●

●

●

●

Exploring Galápagos: One Week Sailing
the Islands (10 day), Exploring Galápagos:
One Week Sailing the Islands + Machu Picchu
and Peru's Land of the Inca (16 day)

Tropical Andes & Colonial Quito Pre-Voyage,
See Quito Pre-Voyage, Ecuador's Amazon:
Yasuní Wildlife Pre-Voyage

All ships include

- Photography Program
- Open Bridge
- World Class Expedition Team
- Excursions
- Tools for Exploration
- Undersea Specialist*
- Meals and Beverages
- Medical Professional*
- Family Friendly
- Free of guest-facing single-use plastic

*National Geographic Delfina does not carry an undersea specialist nor a medical professional. Please call for details.

Take Advantage of Our Special Offers

2026-2027 EARLY BOOKING OFFERS—BOOK BY NOV. 1, 2024: Booking and deposit must be made by Nov. 1, 2024. Valid for new bookings only on departures from Jan. 1, 2026 through Mar. 31, 2027, subject to availability, may not be combinable with other offers, and not applicable on airfare or extensions. Call for details.

BOOK EARLY TO LOCK IN CURRENT RATES ON ALL 2026-2027 DEPARTURES: Pricing will increase on Nov. 2, 2024. Not applicable on airfare or extensions.

BRINGING THE KIDS—SAVE \$1,000 PER CHILD UP TO 22: We believe sharing an expedition with children is a life-enhancing experience. Take \$1,000 off for each child under the age of 23 on any departure.

SAVE UP TO 20% ON BACK-TO-BACK VOYAGES: Save up to 20% on voyage fares on consecutive back-to-back departures. Applicable on select departures only.

BOOK TWO OR MORE VOYAGES AND SAVE 10%: Save 10% on the lowest priced departure when you book two or more expeditions.

BRING A FRIEND AND SAVE 5%: Save 5% when you book two or more cabins on the same departure. Valid on voyage fares only. Deposit, final payments, and

cancellation policies for group travel vary from our regular policies when you book 8 or more guests.

ROUND-TRIP GALÁPAGOS AIR INCLUDED UP TO \$1,200 PLUS INTERNAL AIR: Book between July 26 and October 31, 2024. Airfare included up to a ticket value of \$1,200 per person when booking a select departure of *National Geographic Islander II*, *National Geographic Delfina*, *National Geographic Gemini*, and *National Geographic Endeavour II* on select Galápagos expeditions. Air Included Air Offer must be communicated at time of booking by quoting "AIR INCLUDED". To qualify for the offer, airfare must be ticketed by Lindblad Expeditions. In the case that airfare at the time of booking is higher than \$1,200 per person, guest will be required to pay any amount in excess of \$1,200 per person. Includes internal flights between mainland Ecuador and Galápagos. Internal flights included are worth up to \$520 per guest and does not include additional flights in Peru. Offer is valid for new bookings only, subject to availability, may not be combined with other offers, and is applicable on extensions. Baggage fees may incur additional costs and seat assignments may not be guaranteed. Call for details.

Inclusive Pricing

- Excursions, hotels, and airport transfers, as indicated in the itinerary
- All meals as indicated in the itinerary, both aboard and on shore. Meals are inspired by regional cuisine and locally sourced where possible.
- Hors d'oeuvres inspired by regional cuisine and locally sourced
- 24-hour access to snacks, premium coffees and teas, non-alcoholic beverages, and filtered water
- Selection of exploration tools curated to your destination, such as Zodiacs and glass-bottom boats, stand-up paddleboards, kayaks, snorkeling equipment (including wetsuits, masks, and fins)
- Guidance and company of our leading expedition staff
- Presentations on your destination by expedition staff and expert guest speakers
- The services of a physician, where available
- Morning stretch classes and 24-hour access to exercise equipment, where available
- 24-hour access to lounges, observation decks, library stocked with regionally relevant literature, and other shared spaces
- Complimentary reusable water bottle to fill at onboard water refill stations
- Park and site entrance fees, special access permits, and port taxes

NEW! Complimentary Wi-Fi

We are pleased to offer wireless internet across our expedition fleet through our partnership with Starlink, the world's first and largest satellite constellation. Starlink's low-latency, highspeed internet provides a strong, fast signal in our most remote destinations, whether you're sailing along the shores of Antarctica or through the middle of the Pacific Ocean. Enjoy a complimentary basic Wi-Fi plan aboard our Lindblad Expeditions-National Geographic fleet that

accommodates email, messaging, and social media apps. Upgrades are also available:

- Enhanced Wi-Fi plan: accommodates web browsing, video conferencing, and other functions that require increased bandwidth. Available for purchase at \$25 per day or \$150 for the entire voyage.
- Premium Wi-Fi plan: accommodates most internet needs, including video streaming and uploading and sending large files. Available for purchase at \$50 per day or \$300 for the entire voyage.



Private Charter

Charter with Lindblad Expeditions and sail to the heart of the world's most remote and wild places—with your favorite travel companions. Host your next board meeting, incentive trip with your employees, or gather your friends and family for a special celebration in the Galápagos. When you charter one of our intimate expedition ships exclusively for your group, our team will customize every detail of your experience to ensure your time on board is unforgettable. Discover the wild world on your private voyage with Lindblad Expeditions and cherish the memories forever. We look forward to exploring opportunities with you. Contact us for more information.

Karen Kuttner-Dimitry
Vice President of Affinity & Charter Sales
908-295-3810
karenk@expeditions.com

Log on to expeditions.com

Find everything you need to dream, research, or plan travel to 110+ destinations worldwide.

- Subscribe to our far-ranging email newsletter
- See expeditions.com/stories for articles, videos & Daily Expedition Reports
- Follow us on social media for great posts @lindbladexp on Instagram, Pinterest, and X, and @lindbladexpeditions on Facebook
- Subscribe to our videos on Youtube.com/lindbladexpeditions



Reservation Information

Terms & Conditions: For complete terms and conditions please visit expeditions.com/terms. For best pricing book early. Prices quoted in this brochure are per person based on double occupancy in USD, and based on select departures. Prices quoted are valid at the time of printing, July 31, 2024, are subject to change and availability at time of booking, and are not guaranteed until required deposit is made. Visit expeditions.com or call for all pricing.

Pricing Includes: All accommodations aboard ship or in hotels per itinerary; transfers, regardless of flight or arrival/departure day, with included services; all meals as indicated in the itinerary, both aboard and onshore; beer, wine, cocktails, and spirits aboard the ship (except certain super premium brands which are available for purchase); hors d'oeuvres, 24-hour access to snacks, premium coffees and teas, non-alcoholic beverages, and filtered water; excursions and airport transfers to and from recommended flights, as indicated in the itinerary; gratuities in Guayaquil, Quito and Peru to local guides, drivers and tour escort; exploration tools curated to destination, such as Zodiacs, stand-up paddleboards, kayaks, snorkeling equipment (including wetsuits, masks, and fins); guidance and company of our leading expedition staff; assistance by the Lindblad Expeditions-National Geographic certified photo instructor; presentations by expedition staff and expert guest speakers; basic Wi-Fi; complimentary reusable water bottle; services of a physician, where available; morning stretch classes and 24-hour access to exercise equipment, where available; 24-hour access to lounge, observation decks, library, and other shared spaces; park and site entrance fees, special access permits, and port taxes. Unused services or items included in our programs are non-refundable.

Not Included: Airfare; pre- and post-expedition extensions; additional hotel nights (except when indicated as included); crew gratuities; laundry, spa treatments, scuba diving, and phone services; travel protection plans; and passport, visa, and immigration fees.

Airfare: For all programs, airfare is an additional cost. We will gladly assist in making your air arrangements for a \$50 per person service fee.

Reservations, Deposits, and Final Payments: To reserve your place, an advance payment deposit is required at the time of reservation. Receipt of advance payment deposit indicates your acceptance of the terms and conditions. Final payment schedule can be found online. Visit expeditions.com/terms for complete details about deposits and final payment schedules which may vary by ship.

Travel Protection Plan: We strongly recommend that you take advantage of our Travel Protection Plan. This plan offers comprehensive coverage to protect you from cancellation fees, costs incurred due to trip delays/interruption, medical assistance, and damaged or lost baggage, and provides medical assistance and evacuation during your travels. Our Travel Protection Plan is available for U.S. residents only and may be purchased any time prior to final payment due date. If you are not satisfied for any reason, you may return your plan within 10 days after purchase. Your premium will be refunded if canceled within 10 days, provided you have not already departed on the trip or filed a claim. When so returned, the coverage under the plan is void from the original date of purchase.

Responsibility and Other Terms & Conditions: Certain provisions concerning, among other things, limitations of Lindblad Expeditions' and National Geographic Expeditions' (a division of National Geographic Partners, LLC) liability for loss of property, injury, illness, or death during the voyage will be provided to all guests on the ship's ticket sent prior to departure, and are also available on our website at expeditions.com/terms, or upon request. By registering for a trip, the guest agrees to all such terms and conditions.

Cancellation Policy: Call for details or visit expeditions.com/cancellation-policy

Lindblad Expeditions, LLC is a registered member of the CA Seller of Travel Program #2151120. Registration as a seller of travel does not constitute approval by the State of California.

©2024 Lindblad Expeditions

Lindblad Expeditions and the Eye are the trademarks of Lindblad Expeditions. All rights reserved.

©2024 National Geographic Partners, LLC. All Rights Reserved. NATIONAL GEOGRAPHIC and the Yellow Border are trademarks of National Geographic Society and used with permission.

Photo Credits: ImageBroker/Alamy, Jonathan Aguas, Alexandra Daley-Clark, Joshua Vela Fonseca, Kyle Furey, Bennett Goldberg, Ralph Lee Hopkins, istock, Morfi Jimenez, Sven-Olof Lindblad, Jeff Litton, Emily Mount, Michael S. Nolan, Andrew Peacock, Mark Anthony Ray/Shutterstock, Rich Reid, Marco Ricca, Tom Ritchie, Eteri Okrochelidze/Shutterstock, Daniel Romagosa, Jose R. Calvo Samayoa, Douglas Scaletta, Roberta Schiess, Shutterstock, David Spiegel, Jack Swenson, Jay Vandermeer, David Vargas.

For Reservations:

Contact your travel advisor or Lindblad Expeditions

1.877.689.1962 or 212.261.9000

Reservation Hours: Monday - Friday 9am - 8pm ET

Saturday & Sunday 10am - 5pm ET

Lindblad Expeditions, Inc., 96 Morton Street, New York, NY 10014

For additional information and online reservations,
visit us at: expeditions.com



LINDBLAD EXPEDITIONS
96 MORTON STREET, NEW YORK, NY 10014

PRSRT STD
U.S. POSTAGE
PAID
LINDBLAD
EXPEDITIONS

Account Number:



1.877.689.1962 | WWW.EXPEDITIONS.COM

Travel + Leisure® is a registered trademark of Travel + Leisure Holdco, LLC, a subsidiary of Wyndham Destinations, Inc. and is used under limited license. Lindbald Expeditions is not affiliated with Wyndham Destination, Inc. or its subsidiaries.

Printed on 10% recycled content paper with soy-based inks. We recommend that you pass this along for others to enjoy or recycle. 100% carbon neutral. Committed to being single-use plastic free. We care deeply about the planet, and travel as a powerful force for good. Learn more at expeditions.com/sustainability

GAL-0824

Up To 20% Off Back-To-Back Expeditions

Save up to 20% when you stay onboard for back-to-back voyages or combine your Galápagos expedition with a voyage along the Upper Amazon, a journey through Peru, or both!



Scan QR code for details or visit expeditions.com/gala

